

SUCTION STRAINER-SSC

FEATURES

- REUSABLE SS 100 MESH / 149 MICRON STD.
- ALUMINIUM DIE CAST NUT.
- BOTTOM STEEL CAP.
- CONTINUOUS EPOXY BOND.
- COMPATIBLE FOR PETROLEUM AND MINERAL BASED FLUIDS.
- MAXIMUM WORKIN TEMP 80° C

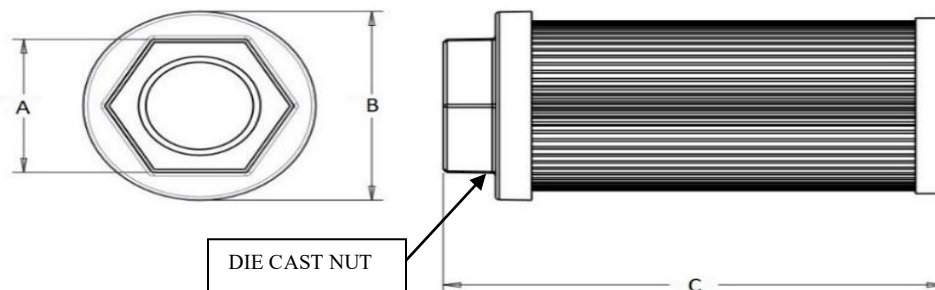

MODEL NUMBER	SIZE (BSP) inches	FLOW LPM	SCREEN AREA (SQ. CM)	A HEX. SIZE	B NUT CAP DIA	C TOTAL LENGTH	WEIGHT KGS
SSC-02	1/4	9	187	24	47	90	0.10
SSC-03	3/8	13	187	24	47	90	0.10
SSC-05	1/2	19	226	30	47	105	0.10
SSC-07	3/4	25	406	35	65	109	0.20
SSC-10	1	40	542	46	65	139	0.20
SSC-15	1-1/4	60	929	51	87	139	0.30
SSC-20	1-1/2	80	1161	60	87	168	0.35
SSC-30	1-1/2	115	1393	60	87	200	0.40
SSC-40	2	155	1806	70	100	235	0.57
SSC-50	2	190	2032	70	100	260	0.60
SS4-75	2-1/2	290	2787	90	150	211	0.86
SSC-100	3	380	3677	100	150	272	1.03
SSC-150	3	570	4838	100	150	345	1.29

MODEL CODE: ASSEMBLY

SSC	-20	FEATURE OPTION 1 PORT THREAD	FEATURE OPTION 2 MICRONS
SERIES	SIZE		
SSC-ALUMINIUM NUT CAP	02 to 150 (REFER ABOVE)	B - BSPP (STD) N - NPT (optional)	149 - SS 100 MESH STD 125 - SS 120 MESH 100 - SS 150 MESH 074 - SS 200 MESH 063 - SS 250 MESH AND - 30 / 60 MESH

Please consult factory, for optional / special feature

NOTE: DIMENSIONS IN MM FOR REFERENCE ONLY